

F Series



F Series

- Very high torque
- Separable push-off ring onto outer ring
- Self-centering
- Self-locking
- Axial movement during clamping

Technical qualification

Tolerance : Shaft h8 / Hub H8

Surface roughness : Ra max. 12.5

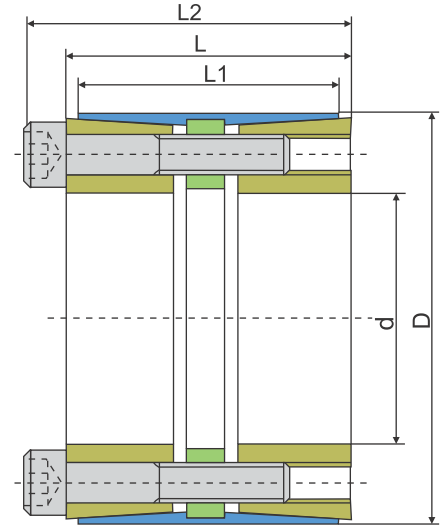

(Screw head height = Screw diameter)

Part No.	Size (mm)	Dimensions (mm)		Rated Load		Contact Pressure		Locking Screws		Weight (Approx.) (kg)
	dxDxL	L1	L2	Axial (KN)	Torque (N.m)	Shaft (Mpa)	Hub (Mpa)	NxType (G. 12.9)	Tightening (N.m)	
OBC-25x50x45 F	25x50x45	39	51	76	950	245	122	8xM6	17	0.50
OBC-28x55x45 F	28x55x45	39	51	76	1070	219	111	8xM6	17	0.60
OBC-30x55x45 F	30x55x45	39	51	76	1150	204	111	8xM6	17	0.60
OBC-35x60x45 F	35x60x45	39	51	76	1340	175	102	8xM6	17	0.70
OBC-38x65x45 F	38x65x45	39	51	76	1450	161	94	8xM6	17	0.70
OBC-40x65x45 F	40x65x45	39	51	76	1530	153	94	8xM6	17	0.70
OBC-42x75x64 F	42x75x64	56	72	141	2970	188	105	8xM8	41	1.00
OBC-45x75x64 F	45x75x64	56	72	141	3150	175	105	8xM8	41	0.90
OBC-48x80x64 F	48x80x64	56	72	166	4000	164	98	8xM8	41	1.40
OBC-50x80x64 F	50x80x64	56	72	192	4850	159	102	8xM8	41	1.26
OBC-55x85x64 F	55x85x64	56	72	194	5160	140	93	8xM8	41	1.36
OBC-60x90x64 F	60x90x64	56	72	249	7460	170	117	10xM8	41	1.46
OBC-65x95x64 F	65x95x64	56	72	256	8400	163	114	10xM8	41	1.55
OBC-70x110x78 F	70x110x78	70	88	371	13800	188	123	10xM10	83	2.9
OBC-75x115x78 F	75x115x78	70	88	401	14000	162	109	10xM10	83	3.0
OBC-80x120x78 F	80x120x78	70	88	463	19400	200	137	12xM10	83	3.3
OBC-85x125x78 F	85x125x78	70	88	472	19600	179	125	12xM10	83	3.4
OBC-90x130x78 F	90x130x78	70	88	472	21200	172	122	12xM10	83	3.5
OBC-95x135x78 F	95x135x78	70	88	486	22400	163	118	12xM10	83	3.7
OBC-100x145x100 F	100x145x100	90	112	660	32900	168	119	12xM12	145	5.5
OBC-110x155x100 F	110x155x100	90	112	700	38600	163	119	12xM12	145	6.0
OBC-120x165x100 F	120x165x100	90	112	786	47100	166	125	14xM12	145	6.4
OBC-130x180x116 F	130x180x116	104	130	924	60100	156	117	14xM14	230	10.0
OBC-140x190x116 F	140x190x116	104	130	1110	77800	174	132	14xM14	230	10.0
OBC-150x200x116 F	150x200x116	104	130	1182	90500	177	138	16xM14	230	10.3
OBC-160x210x116 F	160x210x116	104	130	1207	94600	163	128	16xM14	230	12.4



Part No.	Size (mm)	Dimensions (mm)		Rated Load		Contact Pressure		Locking Screws		Weight (Approx.) (kg)
	dxDxL	L1	L2	Axial (KN)	Torque (N.m)	Shaft (Mpa)	Hub (Mpa)	NxType (G. 12.9)	Tightening (N.m)	
OBC-170x225x146 F	170x225x146	134	162	1483	126000	149	117	14xM16	355	15.7
OBC-180x235x146 F	180x235x146	134	162	1640	149000	156	124	16xM16	355	17.6
OBC-190x250x146 F	190x250x146	134	162	1644	160000	153	120	16xM16	355	19.6
OBC-200x260x146 F	200x260x146	134	162	1700	164000	141	111	16xM16	355	21.5
OBC-220x285x146 F	220x285x146	134	162	1960	215000	153	122	20xM16	355	33.0
OBC-240x305x146 F	240x305x146	134	162	2150	271000	161	128	22xM16	355	37.0
OBC-260x325x146 F	260x325x146	134	162	2270	280000	153	118	22xM16	355	30.0
OBC-280x355x177 F	280x355x177	165	197	3020	422000	142	121	20xM20	690	49.8
OBC-300x375x177 F	300x375x177	165	197	3490	524000	160	132	22xM20	690	50.0

Inch size and special dimensions available upon request.

